

Ned Kelly™



Zinc finish



Black powder coat finish

Features



- Each rail provides storage for a single bike
- Suits bikes with full length mud guards
- Available in Zinc finish or Black powder coat over mild steel
- Provides the ability to lock the main frame and one wheel
- Support prongs with protective coating prevent damage to rim
- Can be used with custom framing - no wall needed

Dimensions

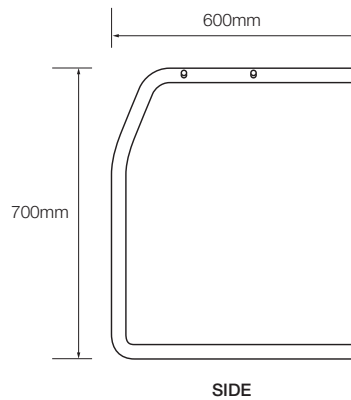

Specifications

Material options

- Zinc finish
- Black powder coat over mild steel
- Stainless steel - *Pre-order only*

Fixing options

- Bolt on to wall
- Fixed to support framing

Recommended fasteners - wall

- Dynabolts (M8 x 40mm)
- Shear Nut security fasteners

Recommended fasteners - framing

- Bolt and nut (M10 x 60mm)
- Tek screws

Dimensions

125mm [w] x 700mm [h] x 600mm [d]

Locking Points

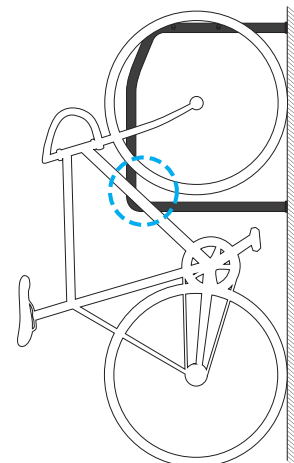

V4.1 - 1/05/2017 | Specification may be subject to change without notice. ©Bicycle Network

Fixing options

Fix to a wall using 4x fasteners or Shear Nuts

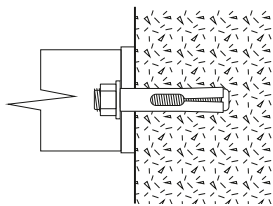

Shown with M8 x 40mm fastener

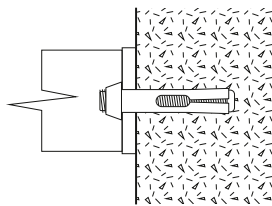

Shown with M8 x 40mm Shear Nuts

Fix to a frame using 4x bolts or Tek Screws

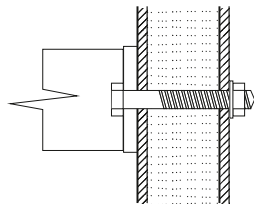

Shown with M10 x 60mm Bolt, Washer & Nut

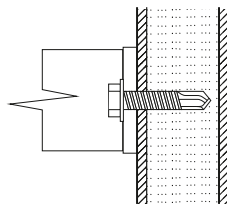

Shown with Tek Screw

Layout guidelines

Option 1:

Fitting 4 Ned Kellys to a wall

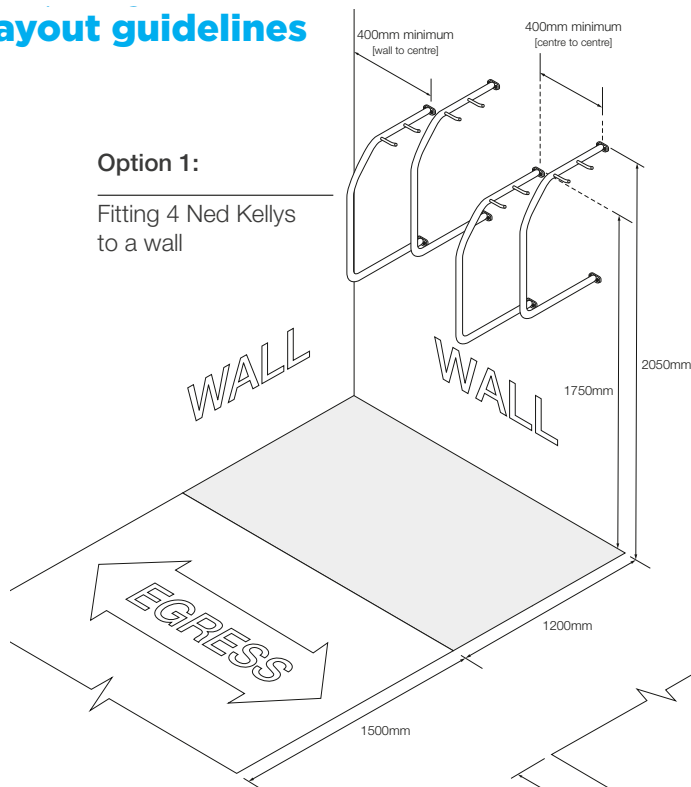

Typical Bicycle Length

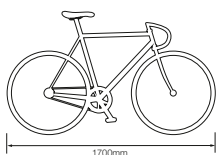

Option 2:

Fitting 7 Ned Kellys to a Duragal steel frame

